

UNIKA 400 VINTAGE GUN METAL



Kitchen Sinks

Code: N156 F86

UNIKA R15 B 400x400 À FLEUR VINTAGE GUNMETAL



DETAILS

| | |
|------------------------|---|
| Coloring | Gun Metal |
| Edge/Installation Type | Flush-mount Top-mount |
| Finish | PVD |
| Material | AISI 304 stainless steel |
| Texture | Vintage |
| Base | 45 cm |
| Dimensions | 440x440 mm |
| Standard fittings | Fixing hooks, gasket, drain, overflow and siphon, boxed packing |
| Mixer holes | No standard holes |

| | |
|---------------|---|
| Built-in hole | View technical data sheet |
|---------------|---|

| | |
|---------|----|
| Drainer | No |
|---------|----|

| | |
|-------|-------|
| Width | 44 cm |
|-------|-------|

| | |
|----------------|--------------|
| Bowl dimension | 400 x 400 mm |
|----------------|--------------|

| | |
|-----------------|--------|
| Number of bowls | 1 bowl |
|-----------------|--------|

| | |
|---------------|------------|
| Waste fitting | 3,5" drain |
|---------------|------------|

FEATURES

| | |
|---------------------------|--|
| Basket 3,5" waste fitting | The drain is equipped with a large 3.5" drain, with the practical basket cap that prevents the discharge of solid parts. |
|---------------------------|--|

| | |
|-----------|--|
| Gun Metal | The Gun Metal finish is obtained by treating steel with a physical process called PVD (Physical Vacuum Deposition) which deposits particles of noble metals on the surface. The result is a unique and refined aesthetic effect, and an improvement of the mechanical properties of the steel which is more resistant to impact and scratches. |
|-----------|--|

| | |
|----------------|---|
| High thickness | 1mm thick steel. A significant thickness, which guarantees the maximum sturdiness and durability. |
|----------------|---|

| | |
|---------------------|---|
| Perimetral overflow | The overflow is always a security on the Foster sinks that prevents the overflow of water in case of oversights. The perimeter drain solution improves aesthetics thanks to its square and essential shape. |
|---------------------|---|

| | |
|--------------|--|
| Small radius | Bowls with squared shapes with a modern design and an increased capacity, for a minimal aesthetics connected with an extreme practicality. |
|--------------|--|

| | |
|-------------|---|
| VINTAGE PVD | The prestigious PVD finish combines with the care for detail of the Vintage finish, to create a combination of unique elegance. |
|-------------|---|

TECHNICAL DATA

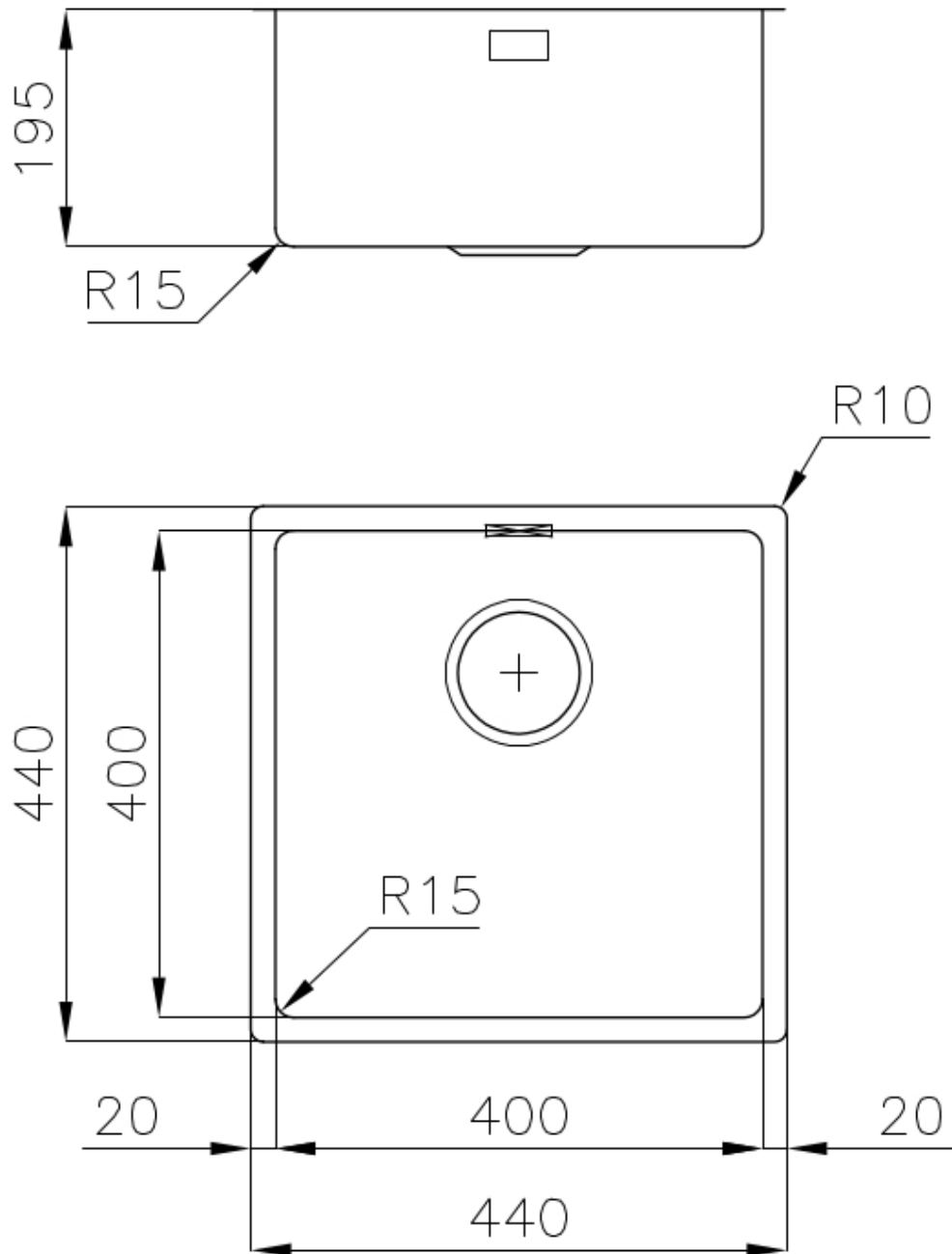

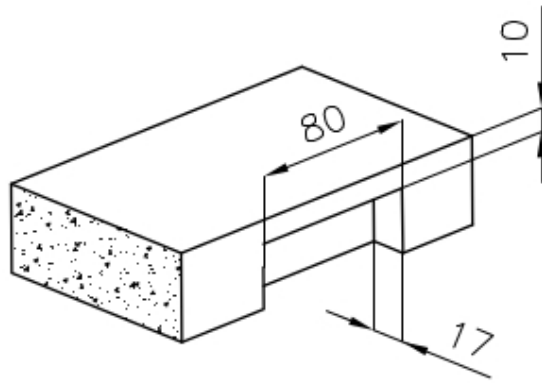

Intaglio per il troppo-pieno
Recess for housing the over-flow

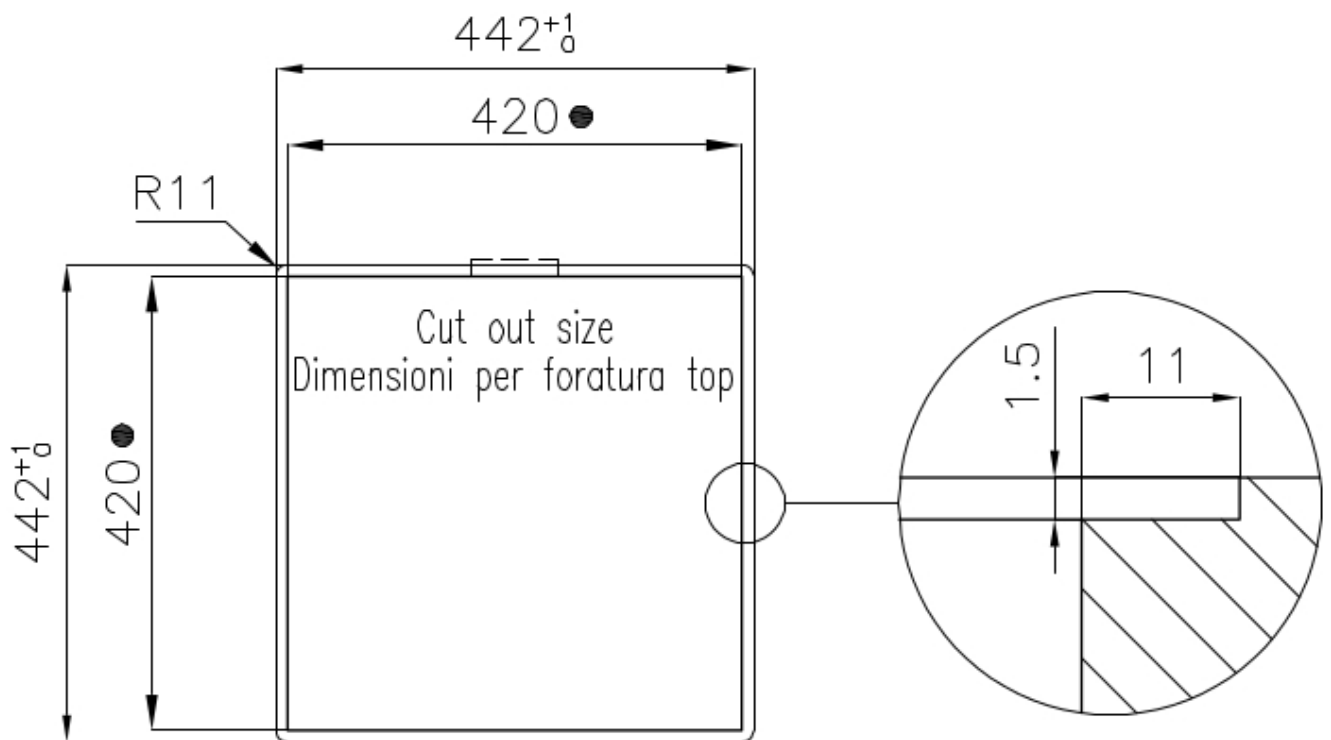

- Built-in cut out for FTS – Foratura per installazione FTS

GALLERY

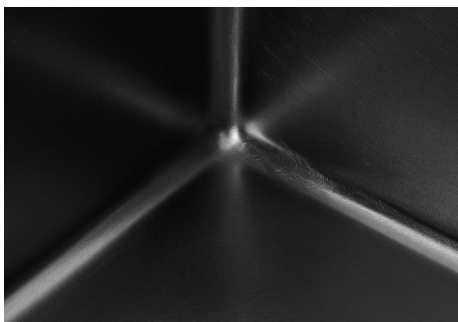

OPTIONAL ACCESSORIES



CUVETTE PERFOREE INOX

A154 F00

* only in combination with the accessory
A644 F04



CUVETTE PLASTIQUE BLANCHE

A153 A00



**GRILLE POR.ASSIETTES INOX
mm214x379**

A100 C03

* only in combination with the accessory
A644 A01

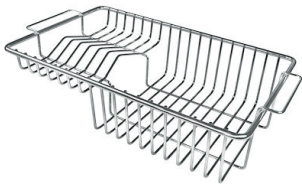

**GRILLE PORTE-ASSIETTES INOX
250x425**

A100 B01



**GRILLE PORTE-ASSIETTES INOX
25x35**

A100 A54

* only in combination with the accessory
A644 F04



**PLANCHE DE DECOUPE CRYSTAL
23x41 CM**

A631 C00



**PLANCHE DE DECOUPE DOUBLE
HDPE**

A644 A01



**PLANCHE DE DECOUPE DOUBLE
IROKO**

A644 F04



**PLANCHE DE DECOUPE HDPE
27x42 CM**

A657 F01



CUVETTE INOX PERFOREE

A151 F00

* only in combination with the accessory
A644 A01



KIT RÂPES ET PLANCHE DE DECOUPE HDPE

A159 A01

* only in combination with the accessory
A644 A01